

B-1-41

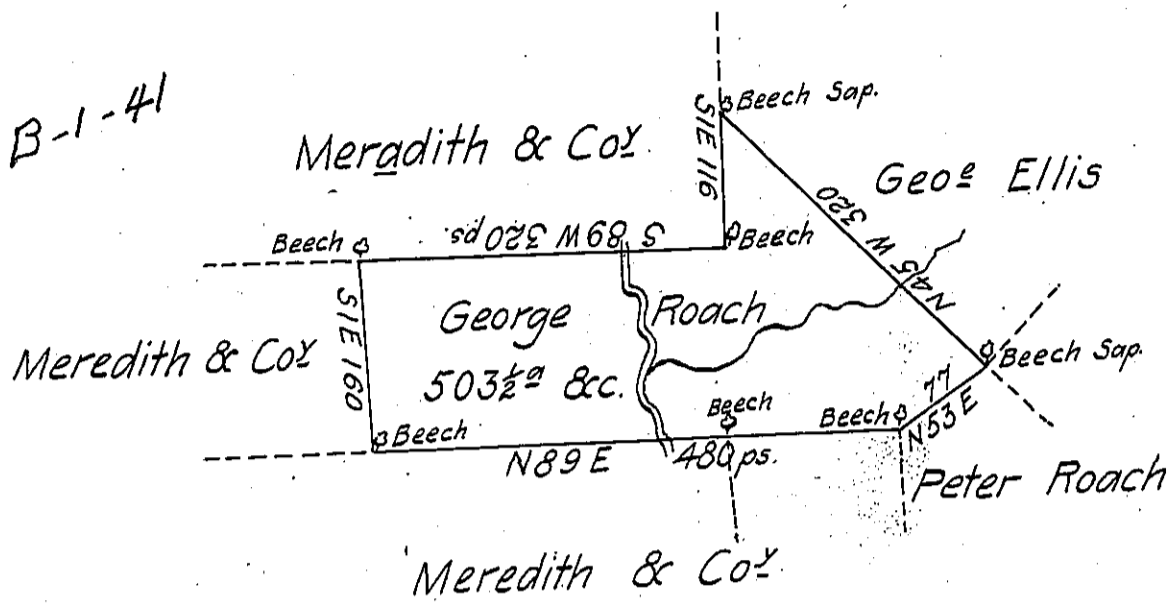

B-21-21

A Draft of a tract of land called—— Situate on the waters of Tunkhannoch Creek Joining Land Surveyed for George Ellis & others in Luzerne County Containing five Hundred & three acres 1/2 & Allow<sup>s</sup> of Six pCent for roads &c Surveyed for George Roach the 4<sup>th</sup> Day of June 1789 in pursuance of a warrant dated the 6<sup>th</sup> Day of May 1789  
by W<sup>m</sup> Gray D.S.

To John Lukens Esqr. }  
Surv<sup>r</sup>: Genl. }

IN TESTIMONY that the above is a copy of the original remaining on file in the Department of Internal Affairs of Pennsylvania, made conformably to an Act of Assembly approved the 16th day of February, 1833, I have hereunto set my Hand and caused the Seal of said Department to be affixed at Harrisburg, this.....fourteenth..... day of.....September..... 1906.

*Loac D Brown*  
Secretary of Internal Affairs